

Details

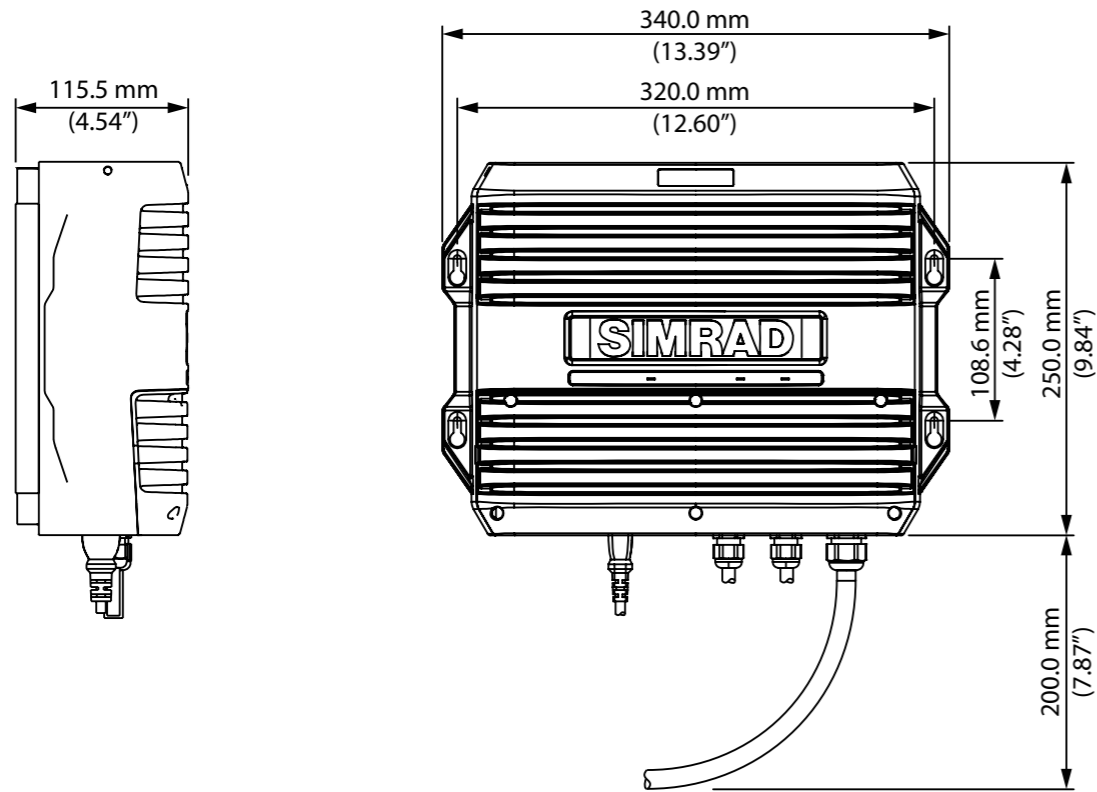

Technical specifications

Environmental	
Operating temperature	-15° C to 55° C (5° F to 131° F)
Storage temperature	-20° C to 60° C (4° F to 140° F)
Equipment category	Protected
IP class	IPx2
Vibration	According to IEC60945 ed. 4.0
Shock	According to RMRS rules (2-020101-040-E Vol 2 - Environmental Test of Equipment)
Electrical	
Input	110/230 V AC, 50/60 Hz (+/- 10%) 6.5 A at 110 V AC 3.5 A at 230 V AC
Output	1 x 52 V DC, 400 W 2 x 24 V DC, 80 W
Fuse rating	DLY 10 A, 250 V, 5x20 mm
Compass safe distance	
Standard magnetic compass	0.3 m (11.81")
Steering magnetic compass	0.24 m (9.45")
Physical	
Weight	5 kg (11.02 lbs.)

SIMRAD

R5000 Power Supply Unit Installation Guide

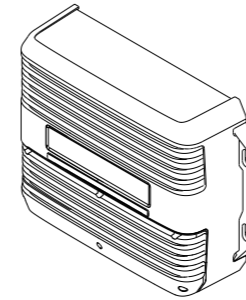

Parts included

- A. R5000 Power Supply Unit
- B. Power cable, 2 m (6.56 ft), (CEE 7/7, IEC C13)
- C. Fuse, 2x
- D. Radar processor power cable, 3 m (9.84 ft)
- E. Terminals and heat shrink tube kit

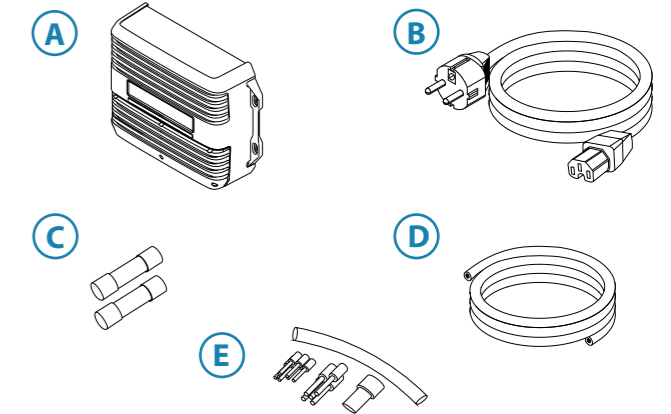

© 2024 Navico Group. All Rights Reserved. Navico Group is a division of Brunswick Corporation.

*Reg. U.S. Pat. & Tm. Off, and ™ common law marks.
Visit www.navico.com/intellectual-property to review the global trademark rights and accreditations for Navico Group and other entities.
• SIMRAD® is a trademark of Kongsberg Maritime AS, Licensed to Navico.

Compliance

Navico declare under our sole responsibility that the product conforms with the requirements of:

- European Council Directive 2014/90/EU on Marine Equipment modified by Commission Implementing Regulation (EU) 2023/1667 (8 August 2023) - Wheelmark

The relevant declaration of conformity is available in the product's section at the following website: www.navico-commercial.com

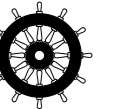

LED indicators

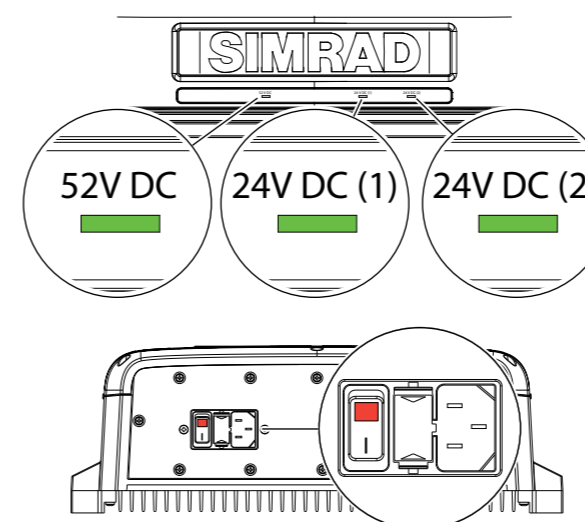

LED	Color	Description
52V DC	Green (constant)	Normal operation
24V DC (x)	Green (constant)	Normal operation
	Off	24V missing R5000 PSU faulty
52V DC 24V DC (x)	Off	No V AC input V AC input out of range Broken fuse R5000 PSU faulty
		R5000 PSU powered on
Power switch	Red (constant)	R5000 PSU powered on
	Off	R5000 PSU powered off No V AC input Broken fuse

→ **Note:** The LEDs at the front are flashing during the startup sequence.

Grounding the unit

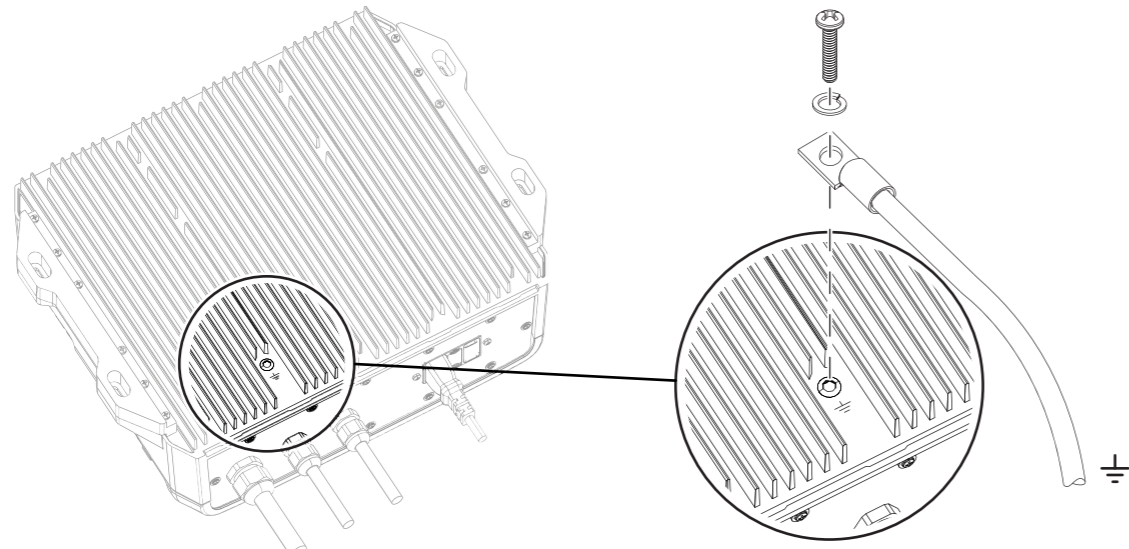

→ **Note:** It is recommended that the power supply unit ground is connected to the vessels bonded ground or a non-bonded RF ground at the closest possible location, using 12 AWG wire (or thicker).

Mounting

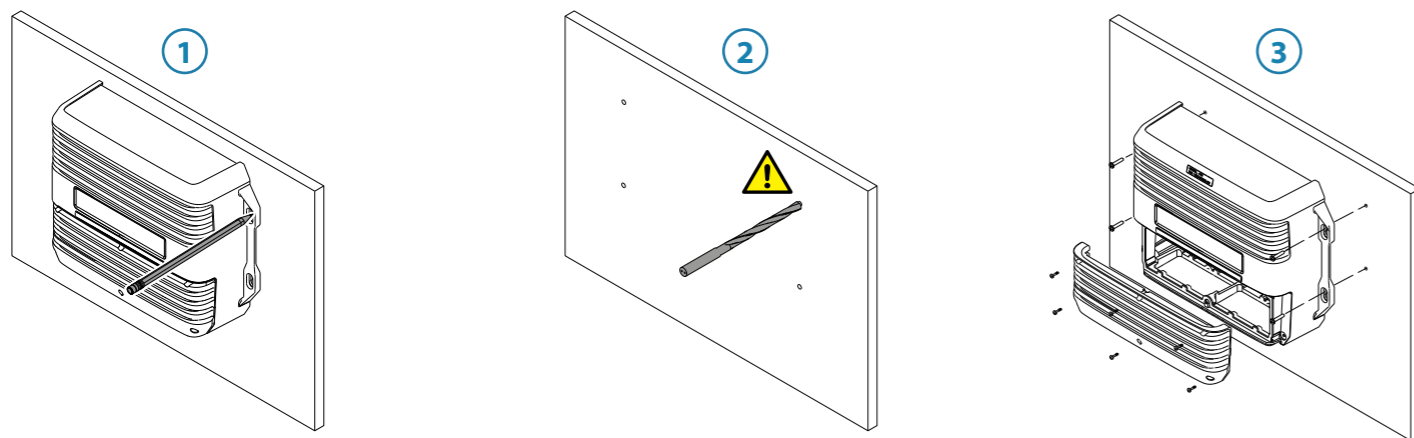

→ **Note:** The power supply must be installed on a vertical surface with the cables exiting downwards.

→ **Note:** Inadequate ventilation and subsequent overheating of the unit may cause unreliable operation and reduced service life. Exposing the unit to conditions that exceed the specifications could invalidate your warranty.

Recommended pilot holes for self-tapping screws:

Material	#10 screw
Soft materials e.g. plywood	Ø 3.7-4.0 mm (5/32")
Hard materials e.g. fiberglass, acrylic, hardwoods	Ø 4.1-4.7 mm (3/16")
Aluminum	Ø 4.2-4.5 mm (0.173")

Internal connections

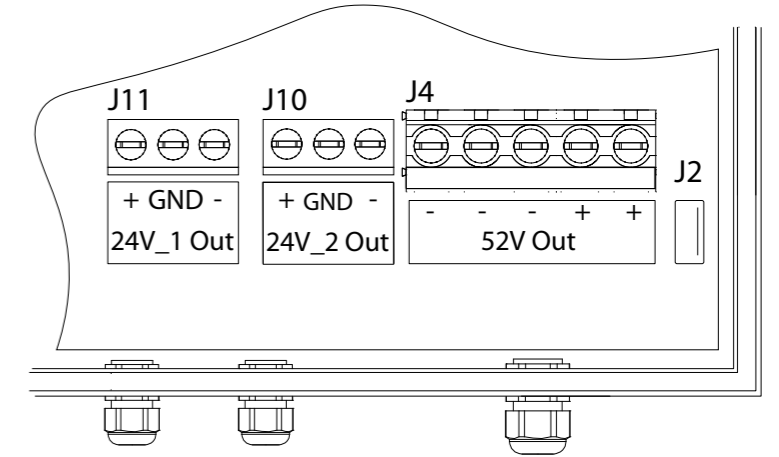
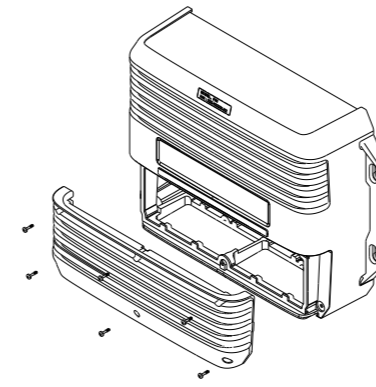

52V Out

52 V DC output
To SRT LAN or HALO 5000

- A. DC negative (black)
- B. 24 V DC (red)
- C. Ground (protect the shield with heat shrink tube)

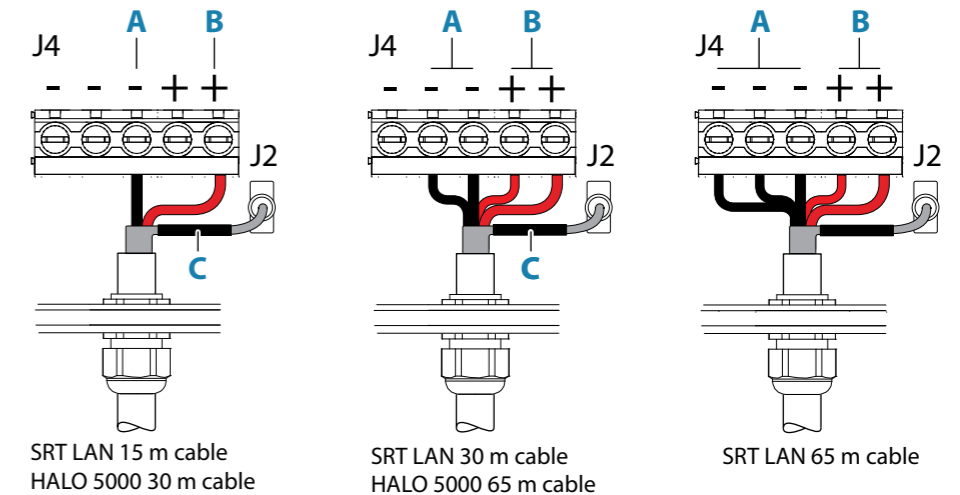

24V_1 Out

24 V DC output
To radar monitor

- A. 24 V DC (red)
- B. DC negative (black)
- C. Ground (green)

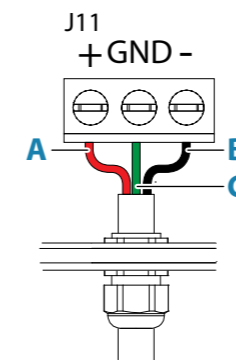

24V_2 Out

24 V DC output
To radar processor

- A. 24 V DC (red)
- B. DC negative (black)

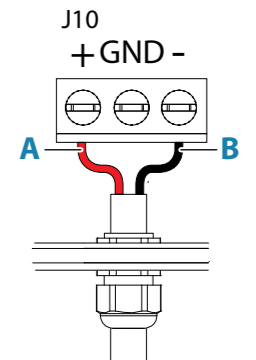

Connectors

- A. Power switch with power indicator
- B. Fuse holder
- C. V AC power input
- D. 24V_1 Out cable gland
- E. 24V_2 Out cable gland
- F. 52V Out cable gland

